

Bavaria 46 cruiser

Bardolino

Technical data

Built: 2017

LOA = Overall length (m): 14,27

Max. beam (m): 4,35

Draft (m): 2,10

Canvassize (m2): 108,00

Engine: Volvo penta 55 kW/75 hp

Heads: 3

Water tank (l): 360

Fuel tank (l): 210

Cabins: 4 + Salon

Berths: 8+1

Unladen weight (kg): 12.600,00

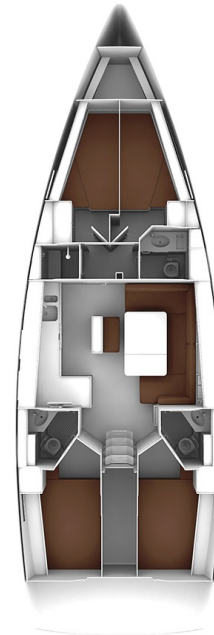

Standard equipment

- BOWTHRUSTER
- BIMINI
- SPRAYHOOD
- ELECTRIC WINDLASS (ANCHOR)
- 2 X STEERING WHEEL
- COCKPIT SHOWER
- COCKPIT TABLE
- WARM WATER

Navigation equipment

- AUTOPILOT
- ECHOLOT
- LOG/SPEEDOMETER
- WIND INSTRUMENT
- GPS CHARTPLOTTER
- VHF-TRANSMITTER
- BARO-/HYGRO-/THERMOMETER
- RADAR REFLECTOR
- CLOCK
- BINOCULARS
- FLAG
- NAVIGATION TOOLS
- HARBOUR HAND BOOKS FOR ADRIATIC SEA
- SHIP REFERENCE BOOKS
- NAUTICAL CHARTS FOR ADRIATIC SEA

Canvas

- ROLL MAIN SAIL
- ROLL GENOA WITH FURLEX

Deck equipment

- ANCHOR WITH CHAIN 50 m
- ACCESSORY ANCHOR WITH 25 m ROPE
- DINGHY WITH OARS AND PUMP
- 6 MOORING ROPES
- 6 FENDERS
- 1 ROUND FENDER
- 2 WINCH HANDLES
- WATER HOSE
- BRUSH
- GANGWAY
- AC 230 V CABLE
- FLOATING ROPE (1 x 30m)
- 1 BOATHOOK

Safety equipment

- 1 LIFE RAFT
- 1 LIFE BUOY
- 10 LIFE JACKETS
- 3 LIFE BELTS WITH SECURITY ROPES
- 2 FIRE EXTINGUISHERS
- FOG HORN
- BOSUNS CHAIR
- LIFE BUOY SIGNAL LIGHT
- JURY RUDDER
- SIGNAL FLARES
- FIRST AID BOX

Accessory equipment

- STARTER-BATTERY
- SERVICE BATTERY
- BATTERY CHARGER
- AC 230 V CABLE
- ELECTRIC BILGE PUMP
- MANUAL PUMP
- 2 GAS BOTTLES
- WATER CAN
- FUEL CAN
- SPARE V-BELT (DRIVE BELT)
- SPARE IMPELLER
- TOOLS SET
- POCKET LAMP
- HAND HELD SPOT LIGHT
- 10 BLANKETS WITH SLIP ON COVERS
- 10 PILLOWS WITH PILLOW SLIPS
- 10 SHEETS
- 20 HANGERS
- 2 TOILET BRUSHES
- LITTLE BROOM AND DUSTPAN

Pantry

- COOKER WITH OVEN
- REFRIGERATOR
- 2 FRYING PANS
- 4 POTS
- 2 BAKING SHEETS
- 1 SALAD BOWL
- 10 PLATES
- 10 SOUP BOWLS
- 10 COFFEE CUPS
- 10 GLASSES
- 10 CUTLERY SET (PAX)
- WATER KETTLE
- ADDITIONAL POTS
- GRATER
- COLANDER
- COFFEE CUPS
- CAN OPENER
- CORKSCREW
- WOODEN SPOON
- BREAD KNIFE
- GARLIC PRESS
- COOKER LIGHTER