

# ELAN 50 IMPRESSION

## “Moonlight”

### Technical data

**Built:** 2015

**LOA = Overall length (m):** 15,20

**Max. beam (m):** 4,68

**Draft (m):** 2,23

**Engine:** Volvo Penta 55 hp

**Heads:** 2

**Water tank (l):** 605

**Fuel tank (l):** 295

**Cabins:** 5 + Salon

**Berths:** 10+2

### Standard equipment

- BIMINI
- SPRAYHOOD
- ELECTRIC WINDLASS (ANCHOR)
- 2 X STEERING WHEEL
- COCKPIT SHOWER
- COCKPIT TABLE
- WARM WATER

### Navigation equipment

- AUTOPILOT
- ECHOLOT
- LOG/SPEEDOMETER
- WIND INSTRUMENT
- GPS CHARTPLOTTER
- VHF-TRANSMITTER
- BARO-/HYGRO-/THERMOMETER
- RADAR REFLECTOR
- CLOCK
- BINOCULARS
- FLAG
- NAVIGATION TOOLS
- HARBOUR HAND BOOKS FOR ADRIATIC SEA
- SHIP REFERENCE BOOKS
- NAUTICAL CHARTS FOR ADRIATIC SEA

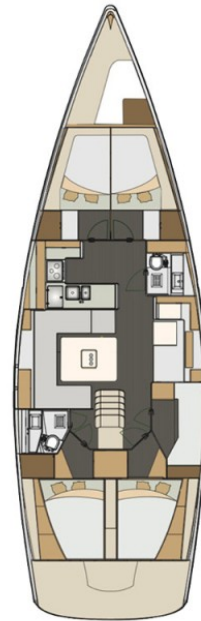

### Canvas

- ROLL MAIN SAIL
- ROLL GENOA WITH FURLEX

### Deck equipment

- ANCHOR WITH CHAIN 45 m
- ACCESSORY ANCHOR WITH 25 m ROPE
- DINGHY WITH OARS AND PUMP
- 4 MOORING ROPES
- 6 FENDERS
- 1 ROUND FENDER
- 2 WINCH HANDLES
- WATER HOSE
- BRUSH
- GANGWAY
- AC 230 V CABLE
- FLOATING ROPE (1 x 30m)
- 1 BOATHOOK

### **Safety equipment**

- 1 LIFE RAFT
- 1 LIFE BUOY
- 12 LIFE JACKETS
- 6 LIFE BELTS WITH SECURITY ROPES
- 2 FIRE EXTINGUISHERS
- FOG HORN
- BOSUNS CHAIR
- LIFE BUOY SIGNAL LIGHT
- JURY RUDDER
- SIGNAL FLARES
- FIRST AID BOX

### **Accessory equipment**

- STARTER-BATTERY
- SERVICE BATTERY
- BATTERY CHARGER
- AC 230 V CABLE
- ELECTRIC BILGE PUMP
- MANUAL PUMP
- 2 GAS BOTTLES
- WATER CAN
- FUEL CAN
- SPARE V-BELT (DRIVE BELT)
- SPARE IMPELLER
- TOOLS SET
- POCKET LAMP
- HAND HELD SPOT LIGHT
- 12 BLANKETS WITH SLIP ON COVERS
- 12 PILLOWS WITH PILLOW SLIPS
- 12 SHEETS
- 24 HANGERS
- 2 TOILET BRUSHES
- LITTLE BROOM AND DUSTPAN

### **Pantry**

- COOKER WITH OVEN
- REFRIGERATOR
- 2 FRYING PANS
- 5 POTS
- 2 BAKING SHEETS
- 1 SALAD BOWL
- 12 PLATES
- 12 SOUP BOWLS
- 12 COFFEE CUPS
- 12 GLASSES
- 12 CUTLERY SET (PAX)
- WATER KETTLE
- ADDITIONAL POTS
- GRATER
- COLANDER
- COFFEE CUPS
- CAN OPENER
- CORKSCREW
- LADLE AND WOODEN SPOON
- BREAD KNIFE AND CARVING LIFE
- GARLIC PRESS
- COOKER LIGHTER